

Cambridgeshire County Council

**THE CITY OF CAMBRIDGE  
(PERMITTED PARKING AND SPECIAL PARKING AREA)  
(WAITING RESTRICTIONS AND STREET PARKING PLACES)  
(CONSOLIDATION) ORDER 2004 (AMENDMENT NO. 10B) ORDER 2005**

Cambridgeshire County Council ("The Council") in exercise of its powers under Sections 1, 2, 3, 4, 19, 32, 35, 45, 46, 49, 63, and 64 of the Road Traffic Regulation Act 1984 ("the Act of 1984") (as amended) and with the Road Traffic Act 1991 and of all other enabling powers and after consultation with the Chief Officer of Police in accordance with Part III of Schedule 9 to the Act of 1984 hereby make the following Order:

1. This Order shall come into operation for all purposes on the 10th day of September 2007 and may be cited as The City of Cambridge (Permitted Parking and Special Parking Area)(Waiting Restrictions and Street Parking Places)(Consolidation) Order 2004 (Amendment No. 10B) Order 2005.
2. In this Order the expression "the Order of 2004" shall mean The City of Cambridge (Permitted Parking and Special Parking Area)(Waiting Restrictions and Street Parking Places)(Consolidation) Order 2004 and any reference to the Order of 2004 shall be construed as a reference to that Order as varied or amended.
3. The Order of 2004 shall be amended and have effect as though plans nos. I19, I22, I23, J19, J20, J21, K19, K20, K21, K22, L19 were deleted and substituted by the plans annexed to this Order.

The COMMON SEAL )  
of CAMBRIDGESHIRE COUNTY COUNCIL )  
was hereunto affixed )  
this 28<sup>th</sup> day of August 2007 )  
in the presence of : )

*KD White*  
*sdw*



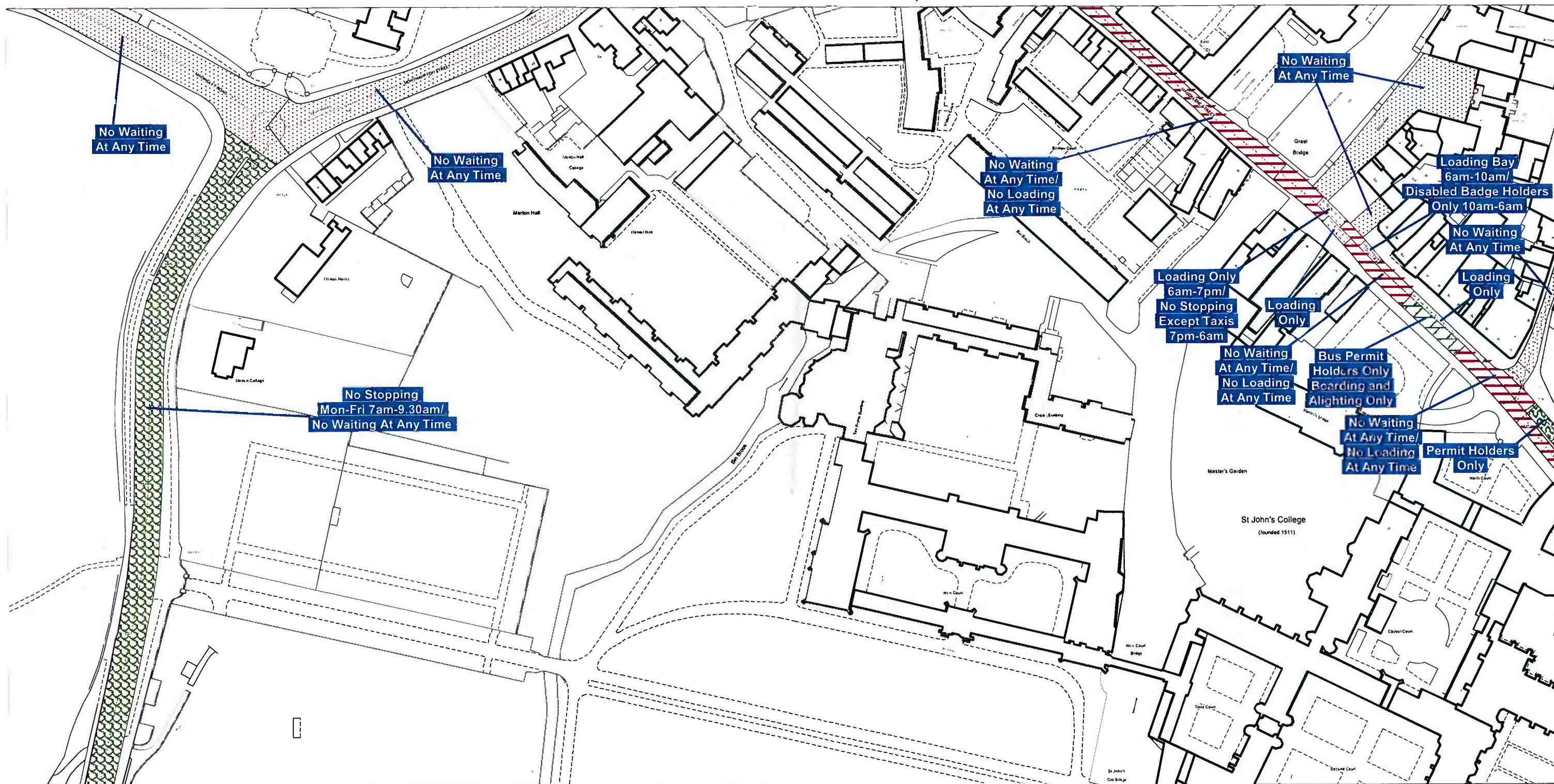

SCALE - 1:1250

THE CITY OF CAMBRIDGE  
(PERMITTED PARKING AND SPECIAL PARKING AREA)  
(WAITING RESTRICTIONS AND STREET PARKING PLACES)  
(CONSOLIDATION) ORDER 2004  
(AMENDMENT NO. 10B) ORDER 2005



H18	I18	J18
H19	<b>I19</b>	J19
H20	I20	J20

AREA CODE:  
**119**



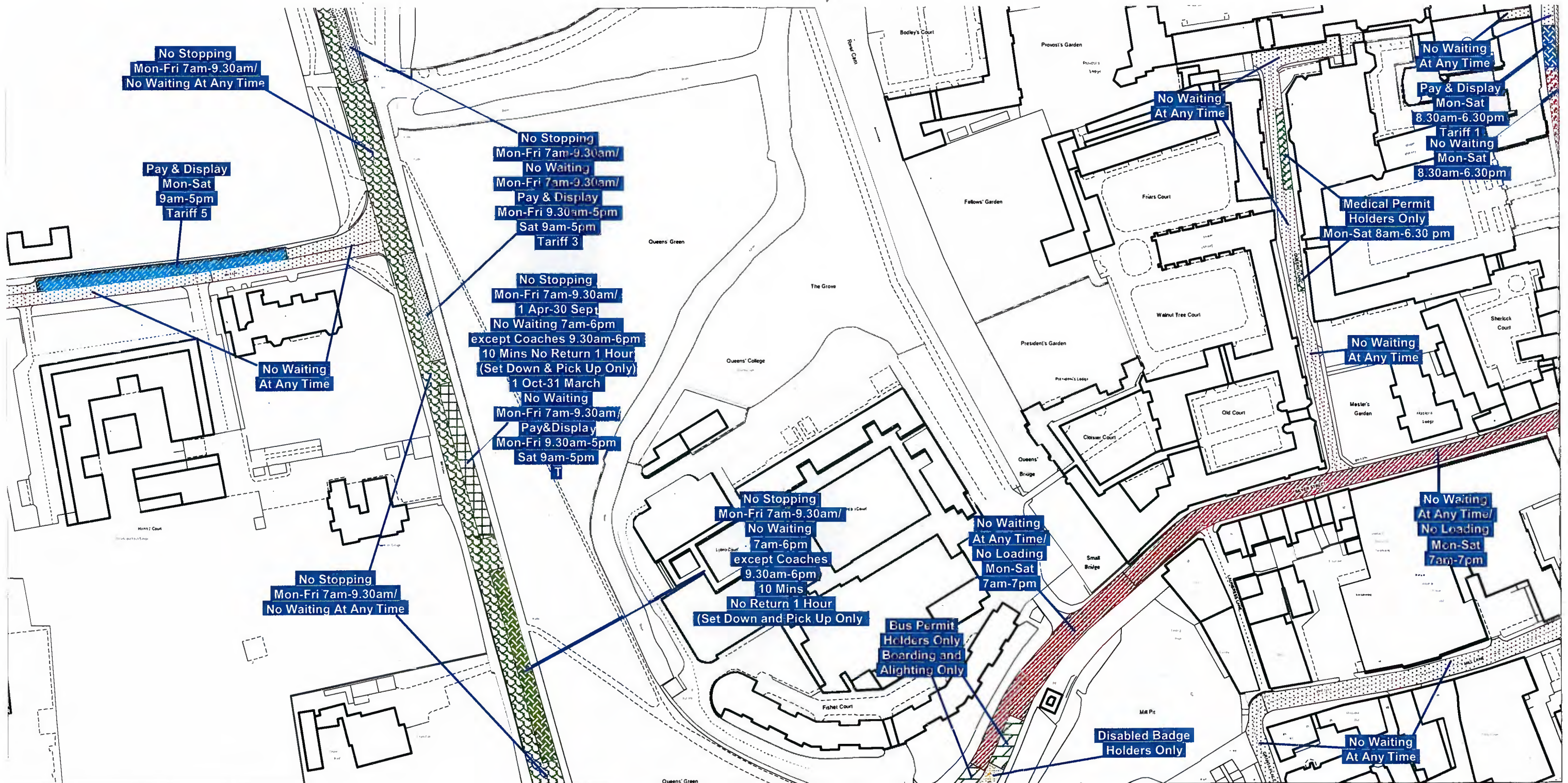

SCALE - 1:1250

THE CITY OF CAMBRIDGE  
(PERMITTED PARKING AND SPECIAL PARKING AREA)  
(WAITING RESTRICTIONS AND STREET PARKING PLACES)  
(CONSOLIDATION) ORDER 2004  
(AMENDMENT NO. 10B) ORDER 2005



H21	I21	J21
H22	<b>I22</b>	J22
H23	I23	J23

**AREA CODE:**  
**I22**



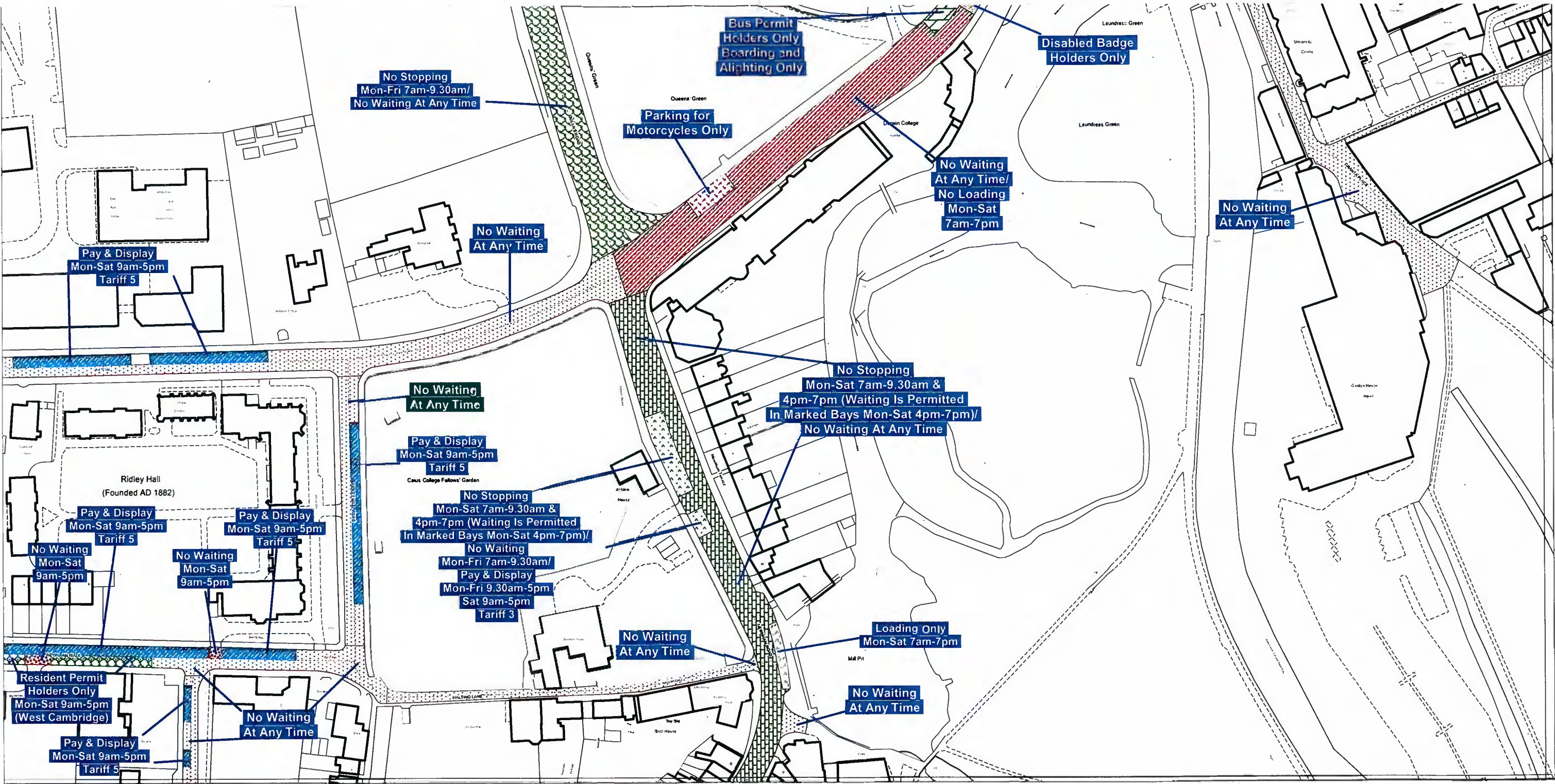

SCALE - 1:1250

THE CITY OF CAMBRIDGE  
(PERMITTED PARKING AND SPECIAL PARKING AREA)  
(WAITING RESTRICTIONS AND STREET PARKING PLACES)  
(CONSOLIDATION) ORDER 2004  
(AMENDMENT NO. 10B) ORDER 2005



H22	I22	J22
H23	<b>I23</b>	J23
H24	I24	J24

AREA CODE:  
I23



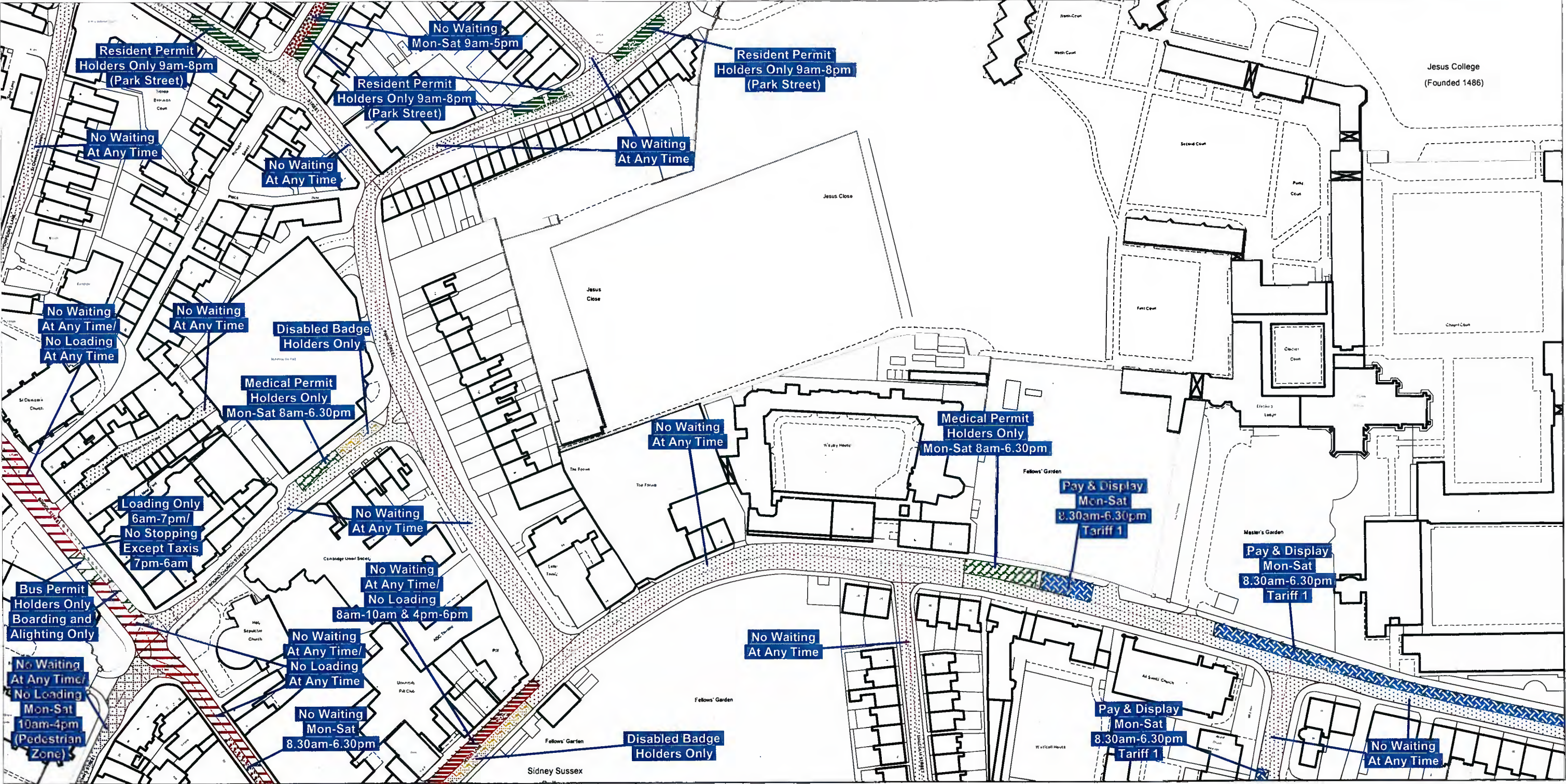

SCALE - 1:1250

THE CITY OF CAMBRIDGE  
(PERMITTED PARKING AND SPECIAL PARKING AREA)  
(WAITING RESTRICTIONS AND STREET PARKING PLACES)  
(CONSOLIDATION) ORDER 2004  
(AMENDMENT NO. 10B) ORDER 2005

Cambridge City Council, The Guildhall, Cambridge, CB2 3QJ



Cambridgeshire  
County Council

I18	J18	K18
I19	<b>J19</b>	K19
I20	J20	K20

AREA CODE:  
J19



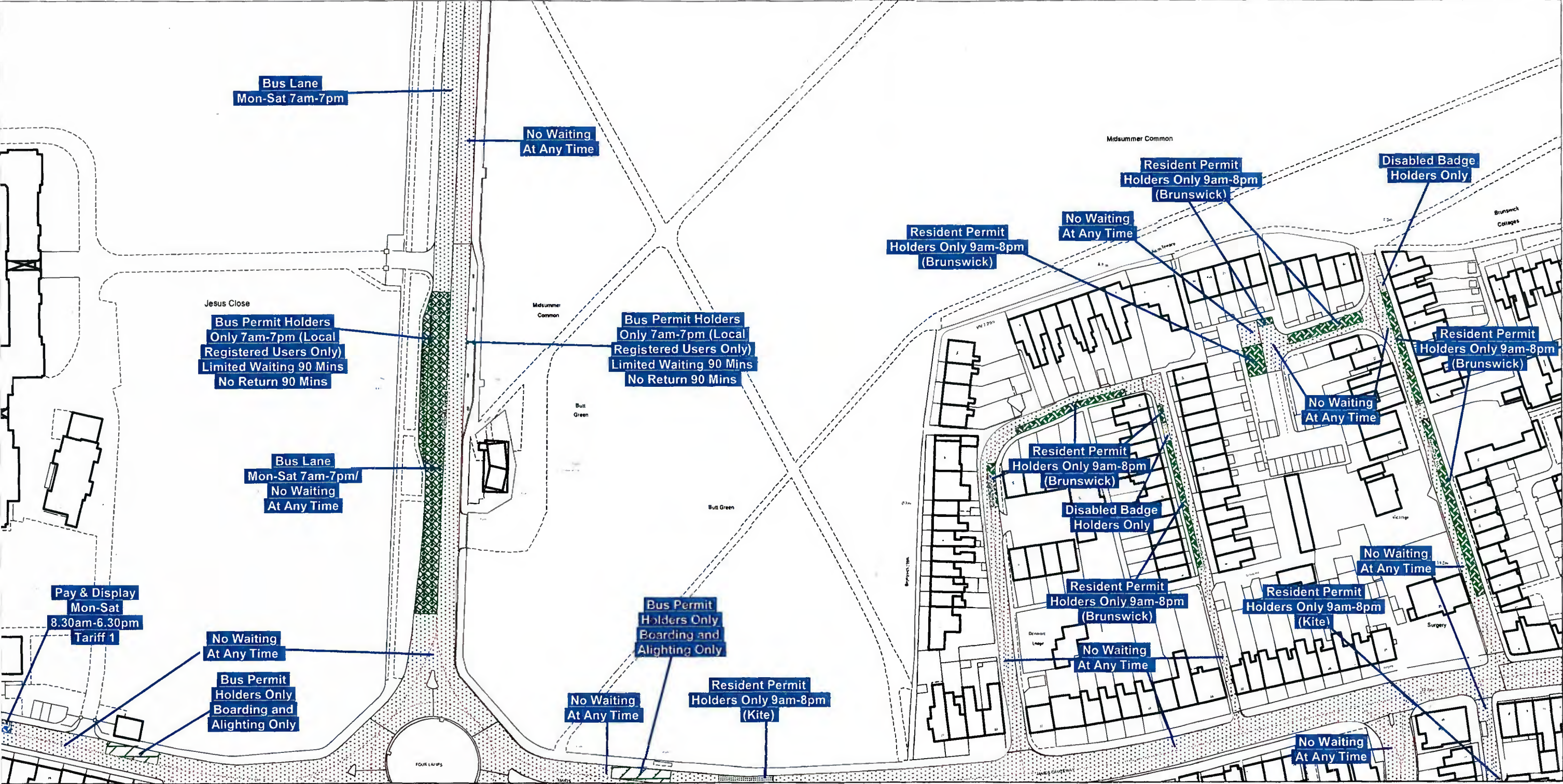

SCALE - 1:1250

THE CITY OF CAMBRIDGE  
(PERMITTED PARKING AND SPECIAL PARKING AREA)  
(WAITING RESTRICTIONS AND STREET PARKING PLACES)  
(CONSOLIDATION) ORDER 2004  
(AMENDMENT NO. 10B) ORDER 2005



Cambridgeshire  
County Council

J18	K18	L18
J19	K19	L19
J20	K20	L20

AREA CODE:  
K19



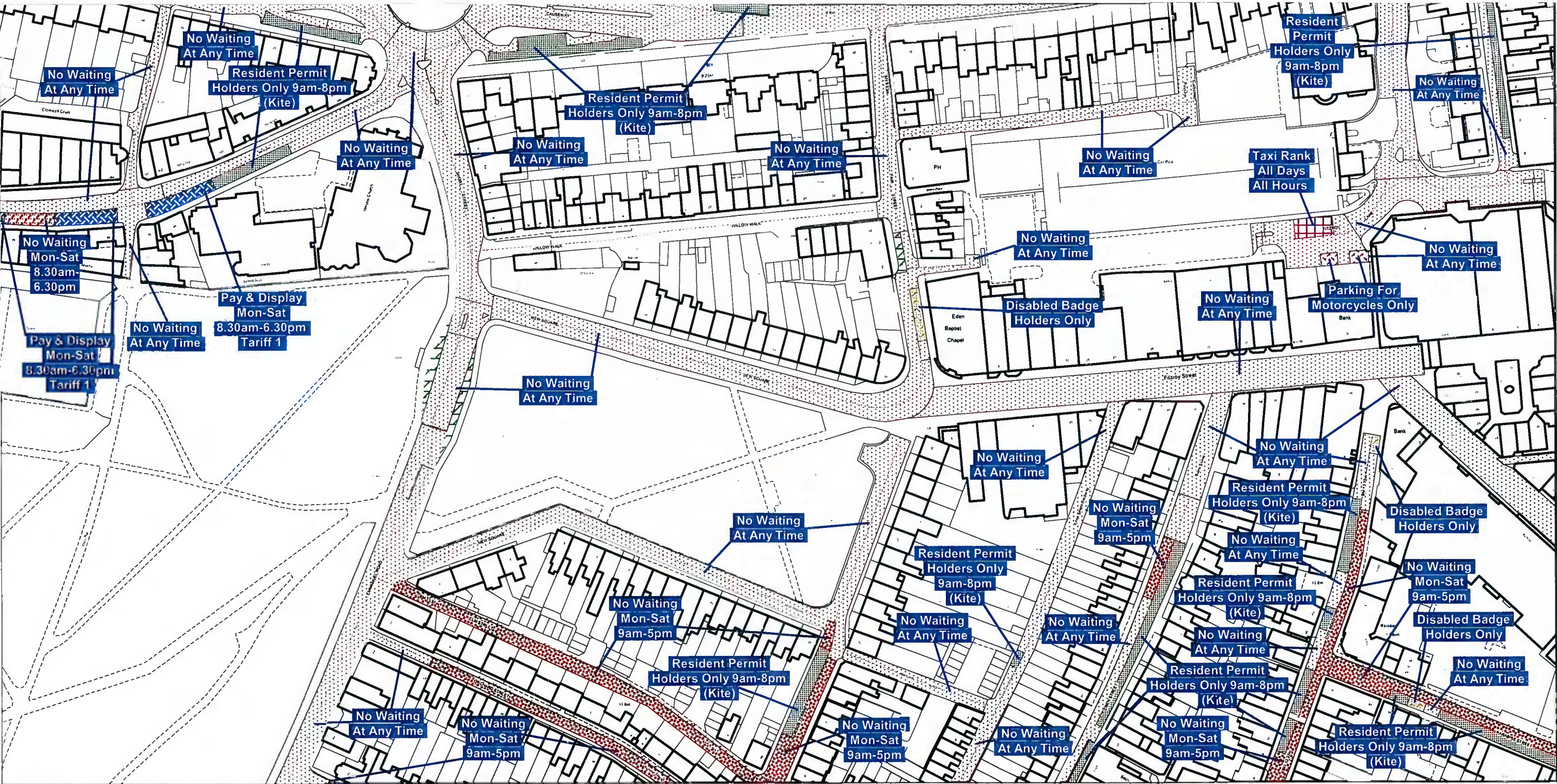

SCALE - 1:1250

THE CITY OF CAMBRIDGE  
(PERMITTED PARKING AND SPECIAL PARKING AREA)  
(WAITING RESTRICTIONS AND STREET PARKING PLACES)  
(CONSOLIDATION) ORDER 2004  
(AMENDMENT NO. 10B) ORDER 2005



Cambridgeshire  
County Council

J19	K19	L19
J20	<b>K20</b>	L20
J21	K21	L21

AREA CODE:  
**K20**



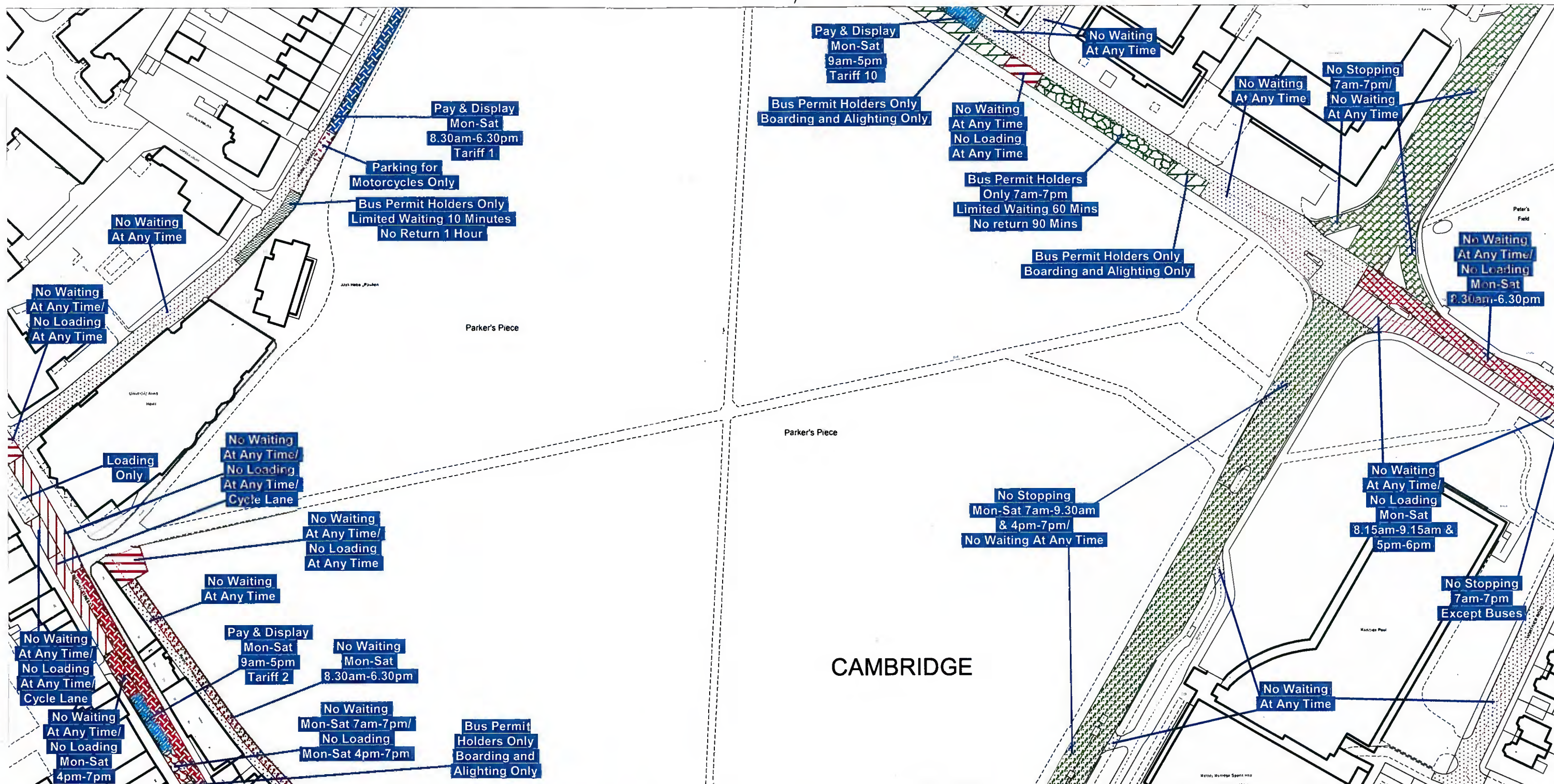

SCALE - 1:1250

THE CITY OF CAMBRIDGE  
(PERMITTED PARKING AND SPECIAL PARKING AREA)  
(WAITING RESTRICTIONS AND STREET PARKING PLACES)  
(CONSOLIDATION) ORDER 2004  
(AMENDMENT NO. 10B) ORDER 2005

Cambridge City Council, The Guildhall, Cambridge, CB2 3QJ



J21	K21	L21
J22	<b>K22</b>	L22
J23	K23	L23

**AREA CODE:**  
**K22**



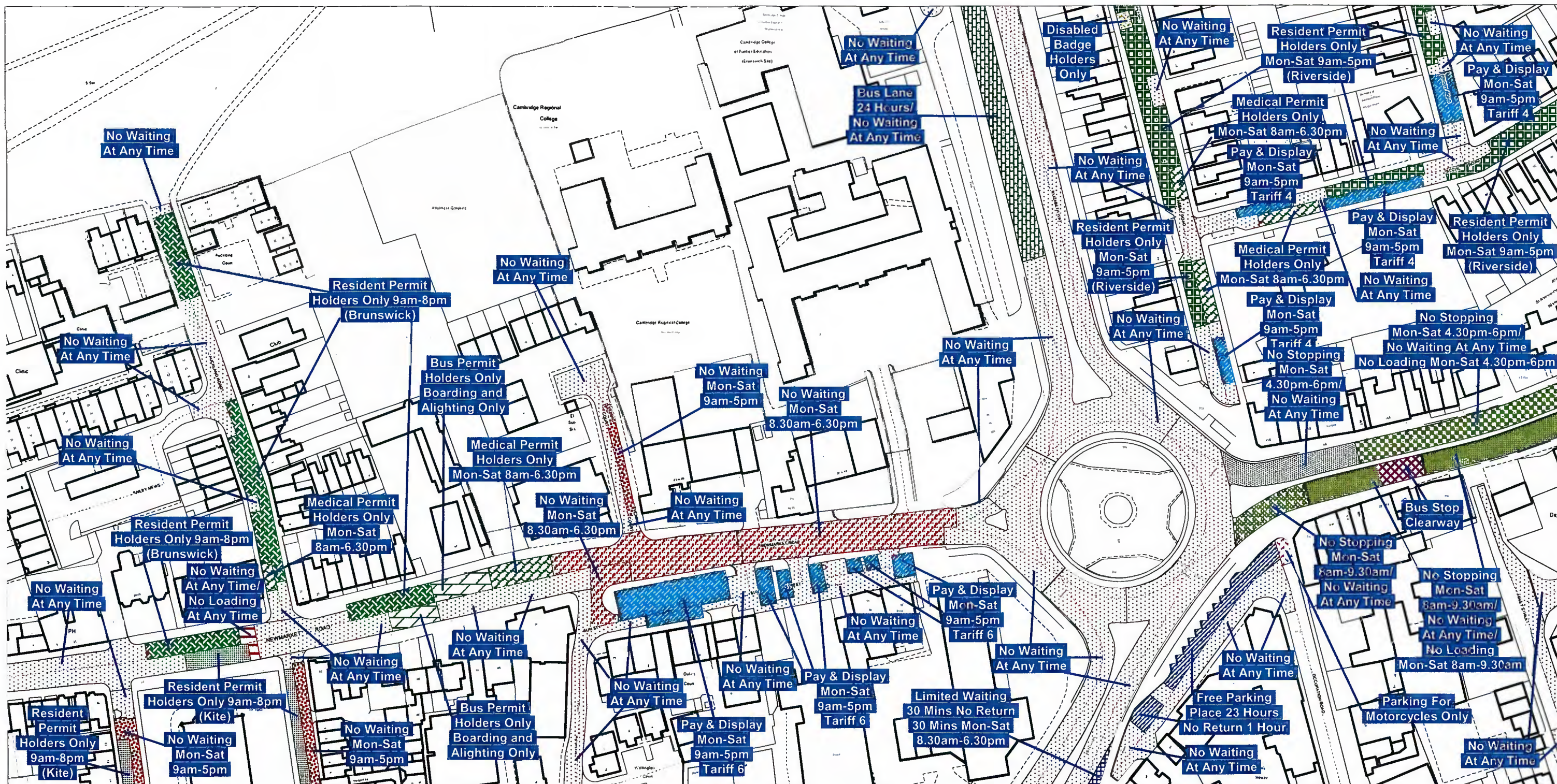

SCALE - 1:1250

THE CITY OF CAMBRIDGE  
(PERMITTED PARKING AND SPECIAL PARKING AREA)  
(WAITING RESTRICTIONS AND STREET PARKING PLACES)  
(CONSOLIDATION) ORDER 2004  
(AMENDMENT NO. 10B) ORDER 2005



Cambridgeshire  
County Council

K18	L18	M18
K19	L19	M19
K20	L20	M20

AREA CODE:  
L19